

1 Topographical Survey
1 : 500

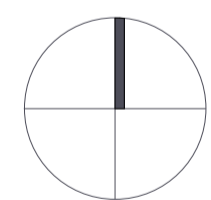

LEGEND:

DENOTES COMPLETED HOUSES / PL REF: 3665/15 - PL 29N.246124. AS AMENDED UNDER 4267/17 & 2133/18

DENOTES HOUSES UNDER CONSTRUCTION / PL REF: 3665/15 - PL 29N.246124. AS AMENDED UNDER 4267/17, 2133/18 & 4306/18

OS MAP REF: 3197-14; 3197-15
ORDINANCE SURVEY IRELAND LICENSE No. 25312609 COPYRIGHT ORDINANCE SURVEY IRELAND AND GOVERNMENT OF IRELAND

LEGEND:

SITE APPLICATION AREA: 10,355 m² (1.04 ha)

AREA UNDER APPLICANTS OWNERSHIP OUTSIDE APPLICATION AREA: 5,331m² (0.53 ha)

OVERALL DEVELOPMENT AREA INCLUSIVE OF DCC LANDS: 20,420m² (2.04 ha)

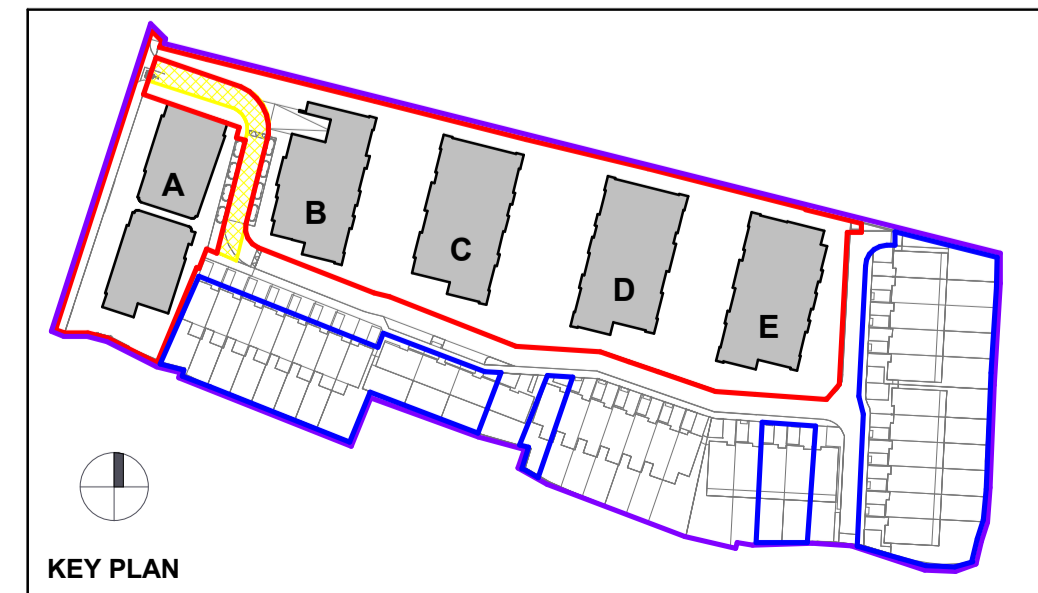

REV	DATE	DESCRIPTION	DRAWN
0	10-06-2020	Issued for Planning	LG

PLANNING

SCANRON
Station Mews, Lindsay Grove, Dublin 9 | www.scanron.com

Drawing Number:
100-12-SHD

Title: Topographical Survey
Project: DANESWELL PLACE

Scale: 1:500 @A1
Date: 10-06-2020