

PROJECT
 PROPOSED STRATEGIC HOUSING DEVELOPMENT AT THE SITE OFF BOTANIC ROAD, GLASNEVIN, CO. DUBLIN

CLIENT
 SCANRON LIMITED, STATION MEWS, LINDSAY GROVE, DUBLIN 9

CONSULTANT
 AECOM
 4th Floor, Adelphi Plaza,
 George's Street Upper, Dun Laoghaire,
 Ireland
 Tel: +353 (0)1 2383100
 www.aecom.com

- NOTES**
- THIS DRAWING IS TO BE READ IN CONJUNCTION WITH ALL OTHER RELEVANT ARCHITECTURAL AND ENGINEERING DRAWINGS. ANY DISCREPANCIES, ERRORS OR OMISSIONS TO BE BROUGHT TO THE ATTENTION OF THE DESIGNER.
 - ALL DIMENSIONS TO BE CHECKED BY THE CONTRACTOR ON SITE PRIOR TO COMMENCEMENT OF WORKS.
 - AECOM LIMITED TO BE INFORMED BY THE CONTRACTOR OF ANY DISCREPANCIES PRIOR TO THE COMMENCEMENT OF WORKS ON SITE.
 - DIMENSIONS OF ALL BOUNDARIES AND ADJOINING ROADS TO BE CHECKED ON SITE PRIOR TO COMMENCEMENT OF WORKS.
 - DO NOT SCALE. ALL MEASUREMENTS AND COORDINATES TO BE CHECKED ON SITE.



A EXISTING SITE ACCESS LAYOUT

0101 Scale: 1:250

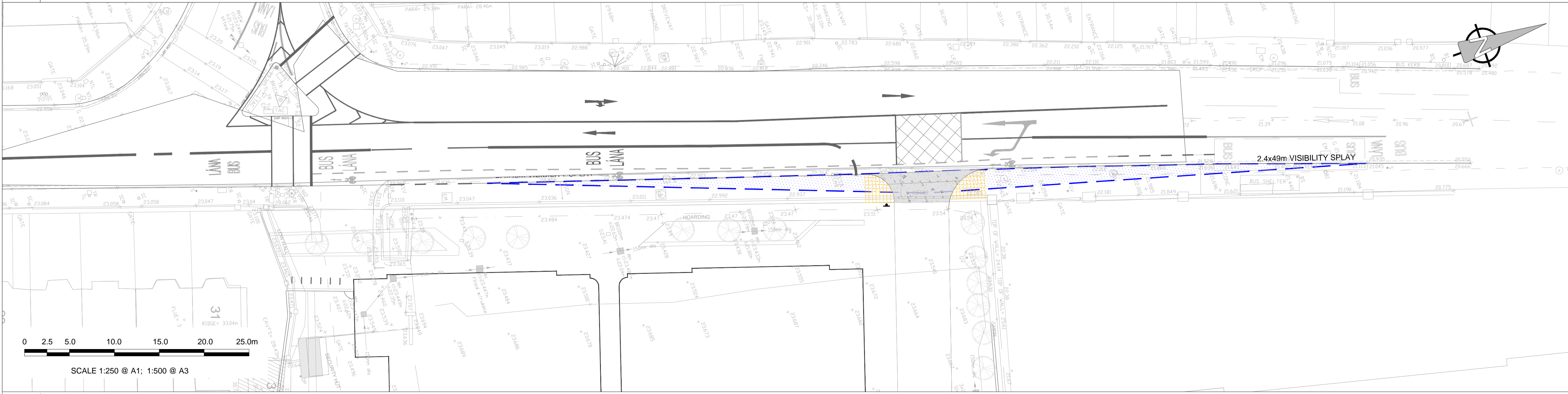

B EXISTING VISIBILITY SPLAY

0101 Scale: 1:250

ISSUE/REVISION

I/R	DATE	DESCRIPTION
1	12.06.2020	ISSUE TO SHD PLANNING
0	23.01.2020	PRE APPLICATION TO ABP



PROJECT NUMBER
 PR-301277

SHEET TITLE
 SITE ACCESS LAYOUT AND VISIBILITY SPLAY

SHEET NUMBER
 BOT-ACM-01-00-DR-CE-10-0101